

Notes:
DO NOT SCALE FROM THIS DRAWING. USE FIGURED DIMENSIONS IN ALL CASES. VERIFY DIMENSIONS ON SITE AND REPORT ANY DISCREPANCIES TO THE ARCHITECTS IMMEDIATELY. THIS DRAWING TO BE READ IN CONJUNCTION WITH THE ARCHITECTS SPECIFICATION. © THIS DRAWING IS COPYRIGHT AND MAY ONLY BE REPRODUCED WITH THE ARCHITECTS PERMISSION.

Drawing Notes:

BLOCK A UNIT MIX

Type A	1 Bed	3	47m ²
Type B	2 Bed 4 Person	9	83.2m ²
Type C	2 Bed 3 Person	1	69.4m ²
Type D	1 Bed	1	50.9m ²
TOTAL		14	1010.1m²

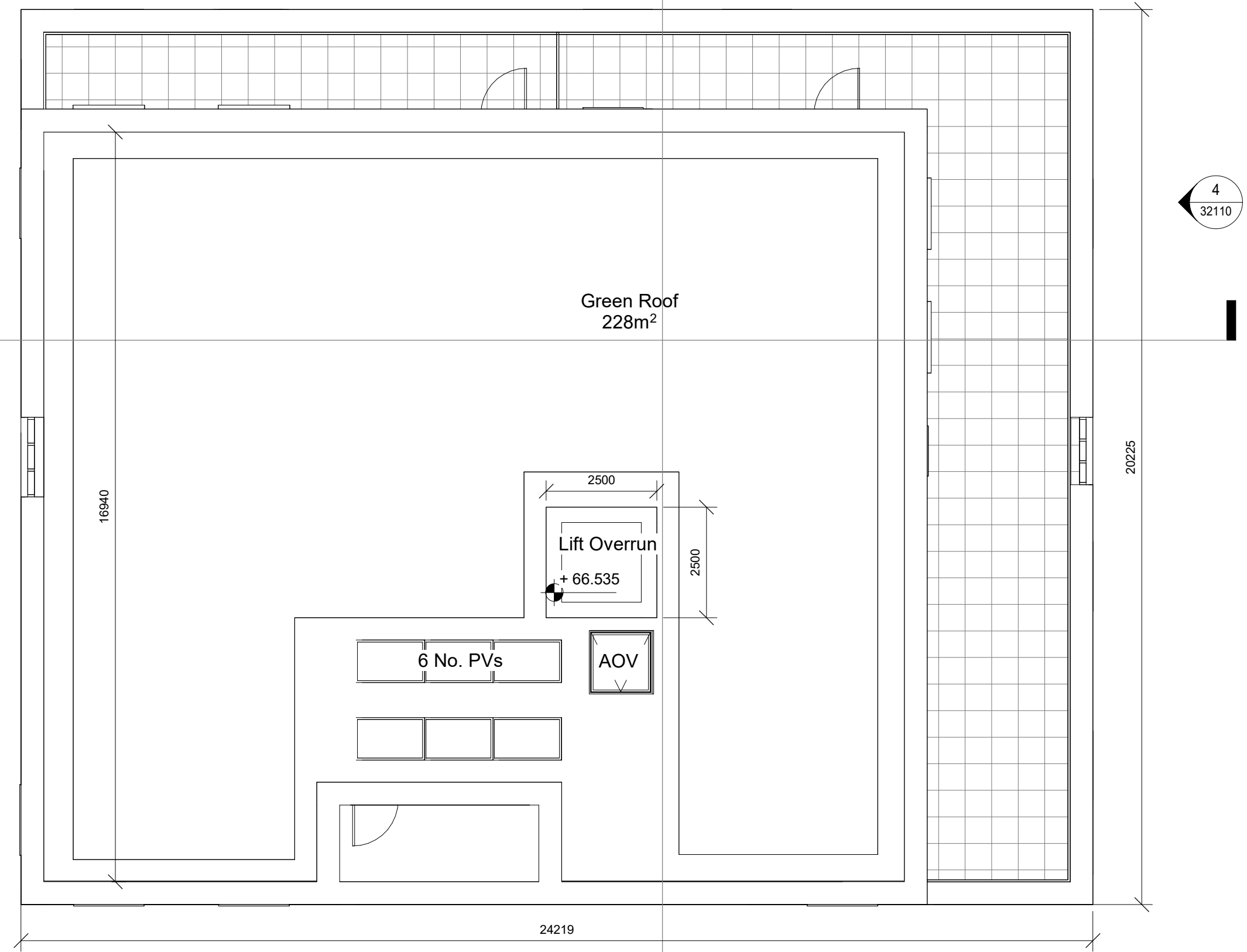

1 Apartment Block A Roof Plan
1 : 100

NOT FOR CONSTRUCTION

Rev	Description	Date	Dm
D	FI Response	01/10/25	AG
C	FI Response	28/09/25	AG
B	Client Name Updated	11/06/25	AG
A	Planning Issue	04/06/25	AG

Crawford
Architecture

The Building Block
Bridge Street, Sligo
F91 XYZN
T: +353 71 930 0090
E: john@crawfordarchitecture.ie

Project:
**Forrest Road
Swords,
Co. Dublin**

Client:
Golden Port Homes Limited

Drawing Title:
Apartment Block A Roof Plan

Job No 23039	Date 30/08/24	Scale@A1 As indicated
Status S2 - Suitable for Information	Drawn By: AG	Checked By: JC
Purpose 3.0 Planning	Checked By: JC	Revision D
Drawing Number 23039-CRA-APA-XX-DR-A-31111		

